



JONES POTTS TAYLOR



3 New Bank Street

Tyldesley, Manchester, M29 8DY

Offers in excess of £150,000

JonesPottsTaylor are pleased to present FOR SALE this extended two bedroom, pavement fronted, detached terrace property. Situated in the popular residential location of Tyldesley town centre, close to major transport and network links, schools, shops and amenities. The property briefly comprises of; entrance into the sitting room, kitchen / dining room, utility room and a downstairs W.C. To the first floor are two double bedrooms and a family bathroom with three piece suite. Outside offers a enclosed, wrap around, low maintenance garden. Viewings for this property are a must to appreciate the sought after location and access to major transport links.

- No Onward Chain
- Popular Residential Location
- Close To Major Transport & Network Links
- Utility Room & Downstairs W.C
- Two Double Bedrooms
- Gas Central Heating & UPVC Double Glazed Windows

Viewing

Please contact our Jones Potts Taylor Office on 01942 368600 if you wish to arrange a viewing appointment for this property or require further information.

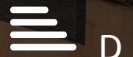

Floor Plan

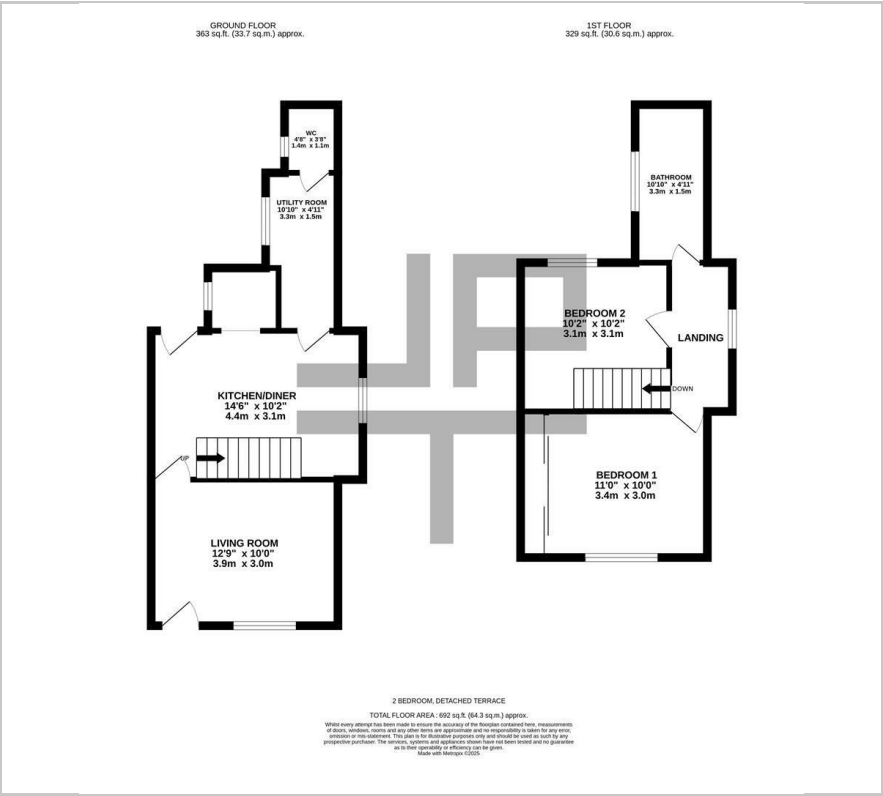

Area Map



Energy Efficiency Graph

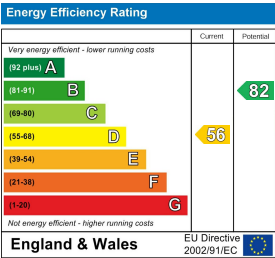

These particulars, whilst believed to be accurate are set out as a general outline only for guidance and do not constitute any part of an offer or contract. Intending purchasers should not rely on them as statements of representation of fact, but must satisfy themselves by inspection or otherwise as to their accuracy. No person in this firm's employment has the authority to make or give any representation or warranty in respect of the property.