



JONES POTTS TAYLOR



11 Norleane Crescent

, Runcorn, WA7 5ER

Price £279,950

JonesPottsTaylor are delighted to present FOR SALE this well presented, three bedroom extended semi-detached property. Situated on a large corner plot in a sought after residential location in Runcorn, close to transport and network links, schools, shops and amenities. The property briefly comprises of; entrance hallway, living room, kitchen, dining / reception room featuring bi-fold doors that open to the rear garden. To the first floor are two double bedrooms, a single bedroom, a further four piece suite bathroom. To the second floor is a loft room, with eaves storage access also. Outside to the front is an enclosed garden, with driveway with access to the garage, whilst to the side and rear is a large enclosed garden

Viewings are highly recommended to appreciate the location and both the living and outside space.

- Additional Loft Room
- Off Road Parking
- EV Charger
- Large Corner Plot Location
- Potential Development Growth
- Gas Central Heating & Double Glazed UPVC Windows

Viewing

Please contact our Jones Potts Taylor Office on 01942 368600 if you wish to arrange a viewing appointment for this property or require further information.



3



1



1

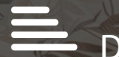

D

Floor Plan

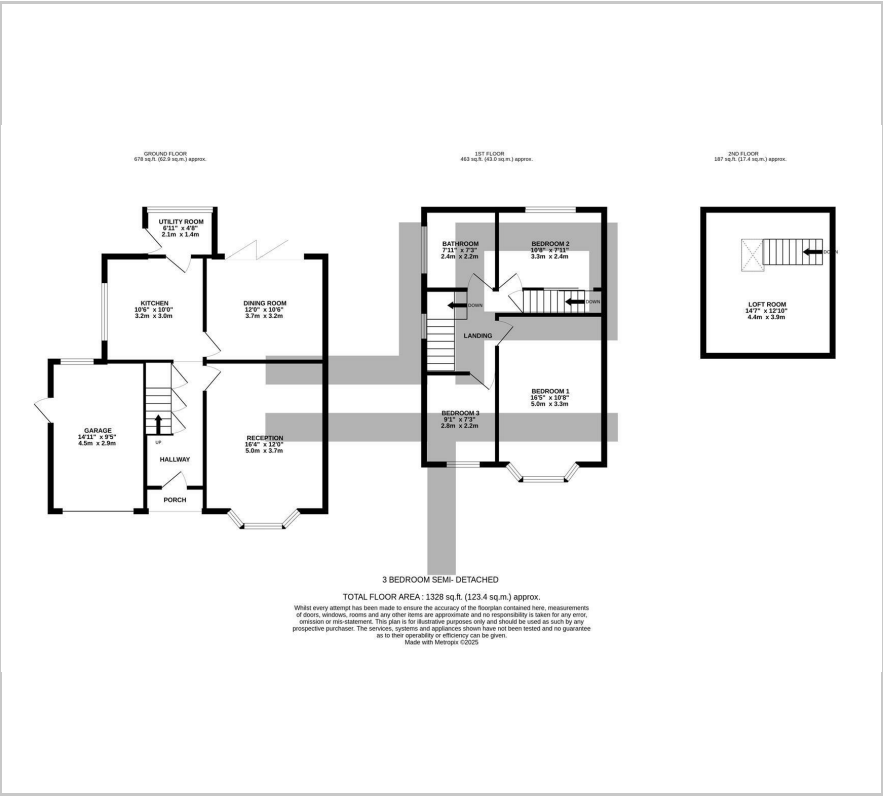

Area Map



Energy Efficiency Graph

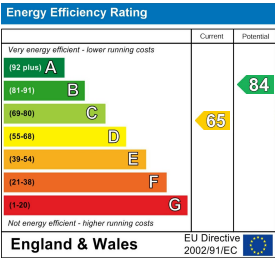

These particulars, whilst believed to be accurate are set out as a general outline only for guidance and do not constitute any part of an offer or contract. Intending purchasers should not rely on them as statements of representation of fact, but must satisfy themselves by inspection or otherwise as to their accuracy. No person in this firms employment has the authority to make or give any representation or warranty in respect of the property.