



JONES POTTS TAYLOR



10 Kirkfell Drive

Middleton, Manchester, M24 5AP

£1,500 PCM

JonesPottsTaylor are delighted to present TO LET this Immaculately presented, four bedroom detached property. Situated in the sought-after residential area in Middleton, close to network and transport links, schools, shops and amenities. The property briefly comprises of; entrance hallway, W.C / cloakroom, sitting room and a kitchen / dining room featuring French doors leading to the rear garden. To the first floor are three double bedrooms, master benefitting from an ensuite and third bedroom features built in wardrobes, a single bedroom, and a further family bathroom with three piece suite. Outside to the front is an open garden and driveway which leads to a detached garage. To the rear is an enclosed low maintenance garden.

Viewings are a must to fully appreciate this properties features / fixtures and are under a scheduled appointments.

Viewing

Please contact our Jones Potts Taylor Office on 01942 368600 if you wish to arrange a viewing appointment for this property or require further information.

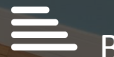

Floor Plan

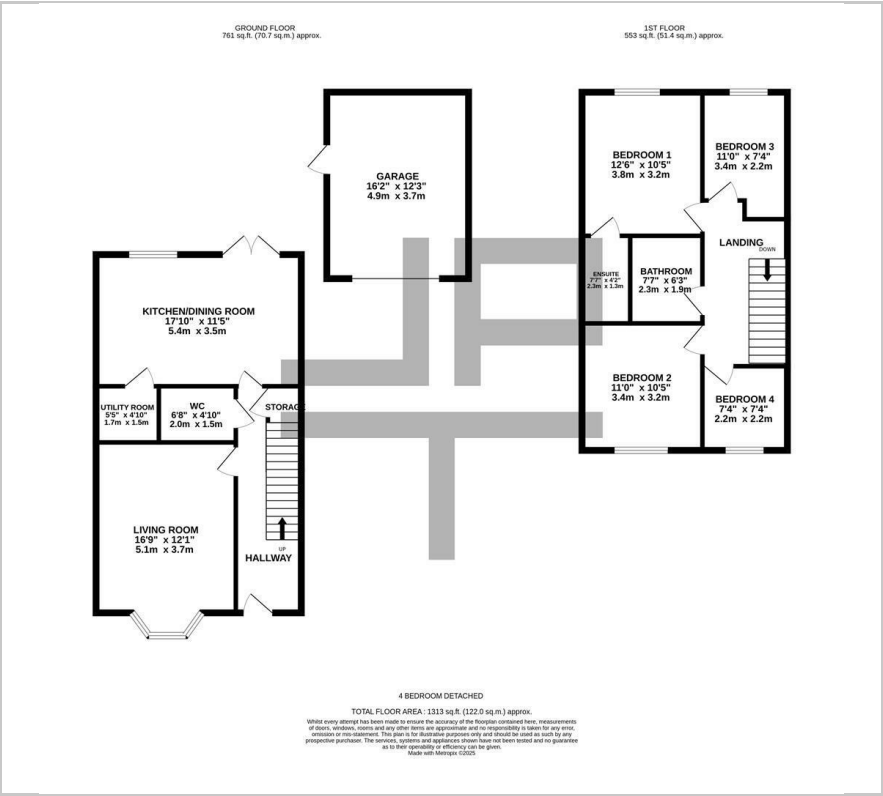

Area Map



Energy Efficiency Graph

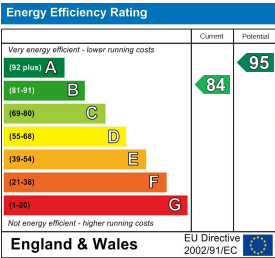

These particulars, whilst believed to be accurate are set out as a general outline only for guidance and do not constitute any part of an offer or contract. Intending purchasers should not rely on them as statements of representation of fact, but must satisfy themselves by inspection or otherwise as to their accuracy. No person in this firms employment has the authority to make or give any representation or warranty in respect of the property.