



320 Manchester Road

Tyldesley, Manchester, M29 8NN

Offers in excess of £300,000

JonesPottsTaylor are delighted to present FOR SALE this immaculately presented, three bedroom extended semi-detached property. Situated in the sought after residential location of Tyldesley close to major transport and network links, schools, shops and amenities. The property briefly comprises of; entrance porch, hallway, downstairs W.C, utility room, open plan style kitchen / dining / living room with feature log burner and French doors which lead to the rear garden. To the first floor are three good sized bedrooms, two rooms benefitting from fitted wardrobes, and a further three piece shower room. Outside to the front is a low maintenance garden and private driveway for multiple cars, whilst to the rear is a enclosed garden featuring a renovated workshop / garden house. External access to a cellar offers additional storage space.

Viewings are highly recommended to appreciate the prime location and both the living / outside space.

- Sought After Location
- Tenure Freehold
- South Facing Garden
- Close To Transport And Network Links
- Ample Off Road Parking With Private Driveway
- Within Primary & Secondary School Catchment Area

Viewing

Please contact our Jones Potts Taylor Office on 01942 368600 if you wish to arrange a viewing appointment for this property or require further information.

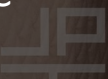
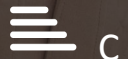

Floor Plan

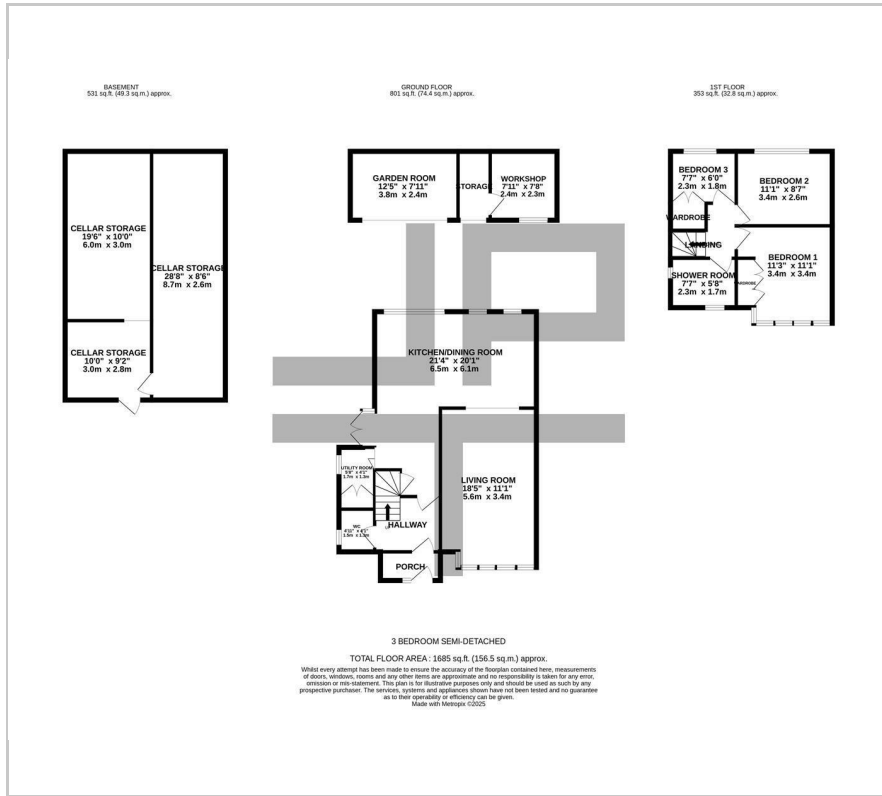

Area Map

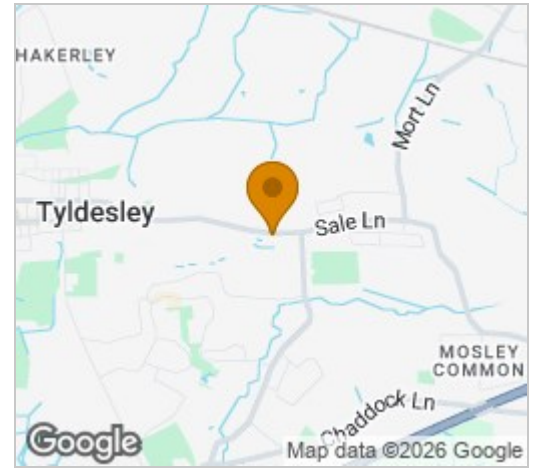

Energy Efficiency Graph

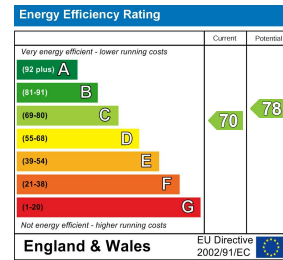

These particulars, whilst believed to be accurate are set out as a general outline only for guidance and do not constitute any part of an offer or contract. Intending purchasers should not rely on them as statements of representation of fact, but must satisfy themselves by inspection or otherwise as to their accuracy. No person in this firm's employment has the authority to make or give any representation or warranty in respect of the property.