



17 Mather Lane

, Leigh, WN7 2FR

£115,000

JonesPottsTaylor are delighted to offer FOR SALE this deceptively spacious, one double bedroom, purpose built apartment. Situated on the ground floor in the sought after Mather House Development within Leigh, close to transport and network links, schools, shops and amenities. The property briefly comprises of; entrance hallway, an open plan living room, dining room and kitchen with integrated appliances, a separate utility / store room, a double bedroom benefitting from fitted wardrobes and a bathroom with three piece suite. The entire living space benefits from 11ft ceilings and industrial/contemporary features. The development itself has resident-only facilities, including, communal entrance and hallway, a parcel drop-off room, stair and lift access, a gymnasium, cinema room, and a residents lounge, dining and kitchen area with a 24/7 concierge.

- No Onward Chain
- Ground Floor Apartment
- Open Plan Style Living
- 24/7 Concierge Service
- Communal Gymnasium, Cinema Room & Reception Room Access
- Electric Only Building

Viewing

Please contact our Jones Potts Taylor Office on 01942 368600 if you wish to arrange a viewing appointment for this property or require further information.

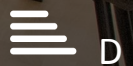

Floor Plan

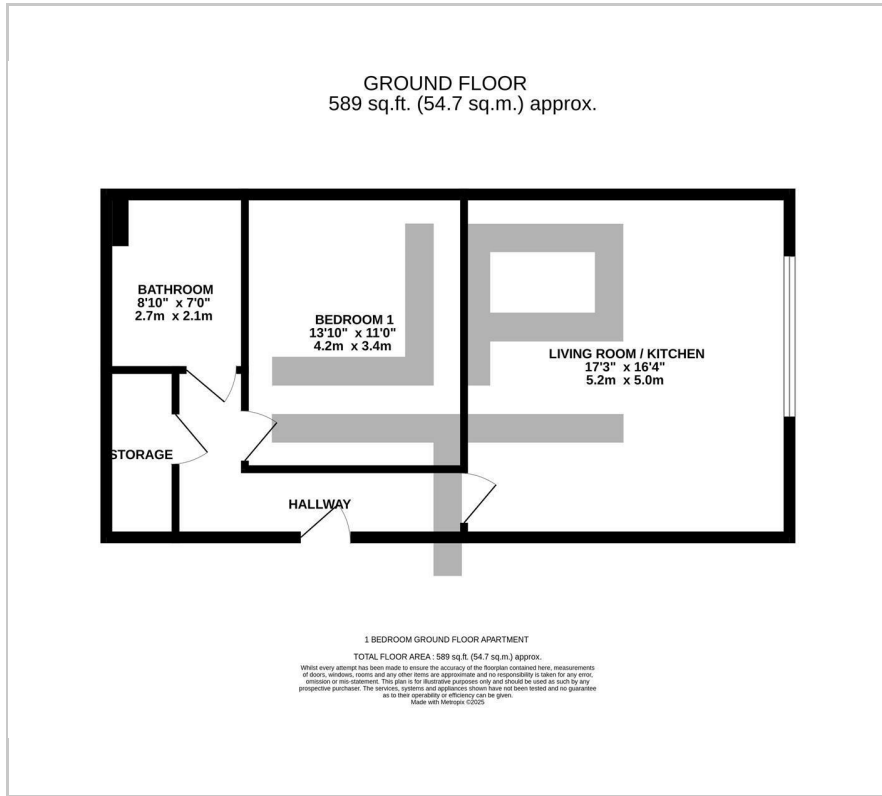

Area Map



Energy Efficiency Graph

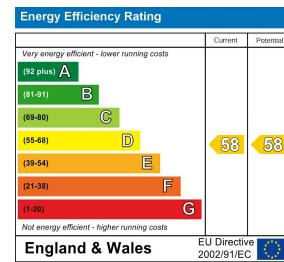

These particulars, whilst believed to be accurate are set out as a general outline only for guidance and do not constitute any part of an offer or contract. Intending purchasers should not rely on them as statements of representation of fact, but must satisfy themselves by inspection or otherwise as to their accuracy. No person in this firm's employment has the authority to make or give any representation or warranty in respect of the property.