



JONES POTTS TAYLOR



1 Runnymede

, Salford, M6 7PJ

£1,250 PCM

JonesPottsTaylor are delighted to present TO LET this three bedroom semi-detached property. Situated on a corner plot, in a sought after residential location in Salford, close to transport and network links, schools, shops and amenities. The property briefly comprises of; entrance porch, hallway, an open plan sitting / dining room, benefitting from sliding doors leading to the rear garden, and a separate kitchen. To the first floor are two double bedrooms, a single bedroom and a family shower room. Outside to the front and rear is an enclosed, low maintenance garden, with a private driveway to the side.

Viewings for this property are to be held under a block viewing schedule

Viewing

Please contact our Jones Potts Taylor Office on 01942 368600 if you wish to arrange a viewing appointment for this property or require further information.

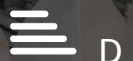

Floor Plan

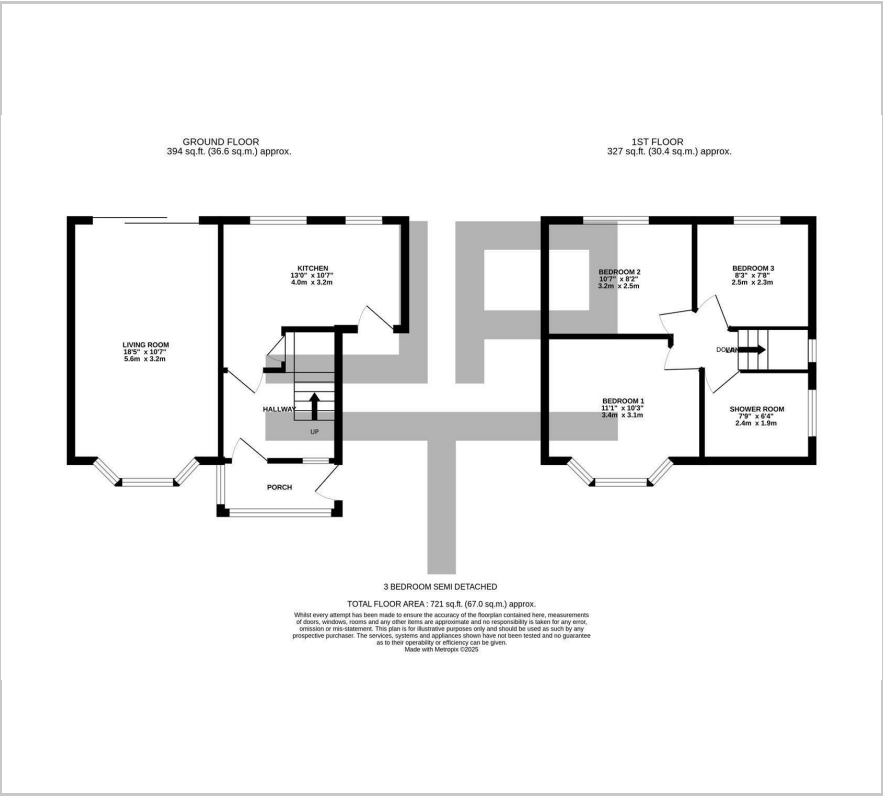

Area Map



Energy Efficiency Graph

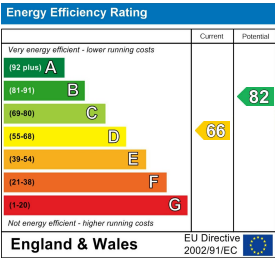

These particulars, whilst believed to be accurate are set out as a general outline only for guidance and do not constitute any part of an offer or contract. Intending purchasers should not rely on them as statements of representation of fact, but must satisfy themselves by inspection or otherwise as to their accuracy. No person in this firms employment has the authority to make or give any representation or warranty in respect of the property.