



5 Westleigh View

, Leigh, WN7 5JD

£160,000

JonesPottsTaylor are delighted to present FOR SALE this deceptively spacious two bedroom mid-terraced property. Situated in a popular residential location in Leigh, central to transport and network links, within walking distance to schools, shops and amenities. The property briefly comprises of; entrance hallway, living room and kitchen / dining room To the first floor are two double bedrooms, and a further family bathroom with three piece suite. Outside to the front and rear are enclosed low maintenance gardens, Viewings for this property are a must to appreciate its location.

- Cul De Sac Location
- TWO Double Bedrooms
- Tenure - Freehold
- Within Walking Distance to Both Primary and Secondary Schools
- UPVC Windows and Doors
- Gas Central Heating

Viewing

Please contact our Jones Potts Taylor Office on 01942 368600 if you wish to arrange a viewing appointment for this property or require further information.

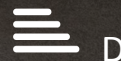

D

Floor Plan

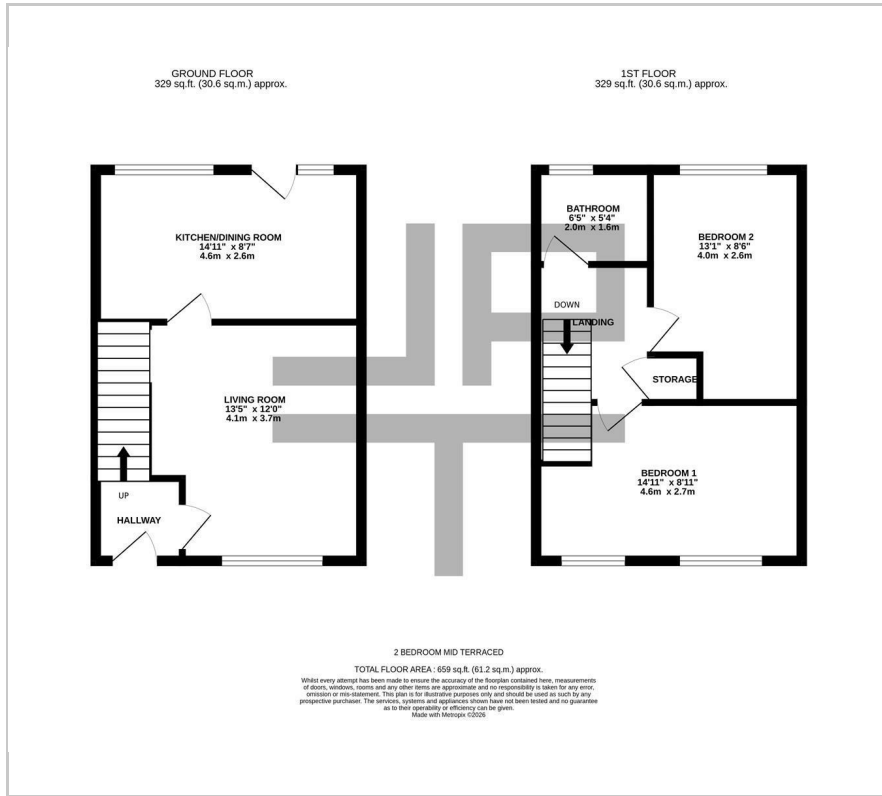

Area Map



Energy Efficiency Graph

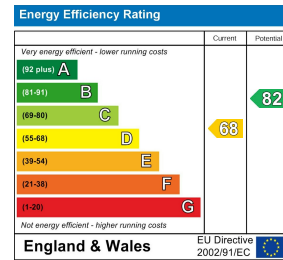

These particulars, whilst believed to be accurate are set out as a general outline only for guidance and do not constitute any part of an offer or contract. Intending purchasers should not rely on them as statements of representation of fact, but must satisfy themselves by inspection or otherwise as to their accuracy. No person in this firm's employment has the authority to make or give any representation or warranty in respect of the property.